

Panduit Part number		Wire range AWG (mm <sup>2</sup> )	TAB SIZE	Housing color	Dim. "F"	Dim. "W"	Dim. "L"	Maximum Wire Insulation Diameter	MINIMUM Wire Insulation Diameter	Tools
Prefix	Pk									Presses: CP-861, CP-860 CP-851, CP-862
DNG18-187FB	-3K	22-18 (0.5 - 1.0)	.187 x .032	Red	.22 (5.6)	.29 (7.4)	.89 (22.6)	.126 (3.20)	.090 (2.29)	CD-800-15 CD9-15A
DNG18-188FB	-3K	22-18 (0.5 - 1.0)	.187 x .020	Red	.22 (5.6)	.29 (7.4)	.89 (22.6)	.126 (3.20)	.090 (2.29)	CD-800-15 CD9-15A
DNG18-250FB	-3K	22-18 (0.5 - 1.0)	.250 x .032	Red	.22 (5.6)	.35 (8.9)	.93 (23.6)	.126 (3.20)	.090 (2.29)	CD-800-15 CD9-15A
DNG14-187FB	-3K	16-14 (1.5 - 2.5)	.187 x .032	Blue	.25 (6.4)	.29 (7.4)	.89 (22.6)	.153 (3.89)	.125 (3.89)	CD-800-16 CD9-16A
* DNG14-188FB (SEE NOTE #7)	-3K	16-14 (1.5 - 2.5)	.187 x .020	Blue	.25 (6.4)	.29 (7.4)	.89 (22.6)	.153 (3.89)	.125 (3.89)	CD-800-16 CD9-16A
DNG14-250FB	-3K	16-14 (1.5 - 2.5)	.250 x .032	Blue	.25 (6.4)	.35 (8.9)	.93 (23.6)	.153 (3.89)	.125 (3.89)	CD-800-16 CD9-16A

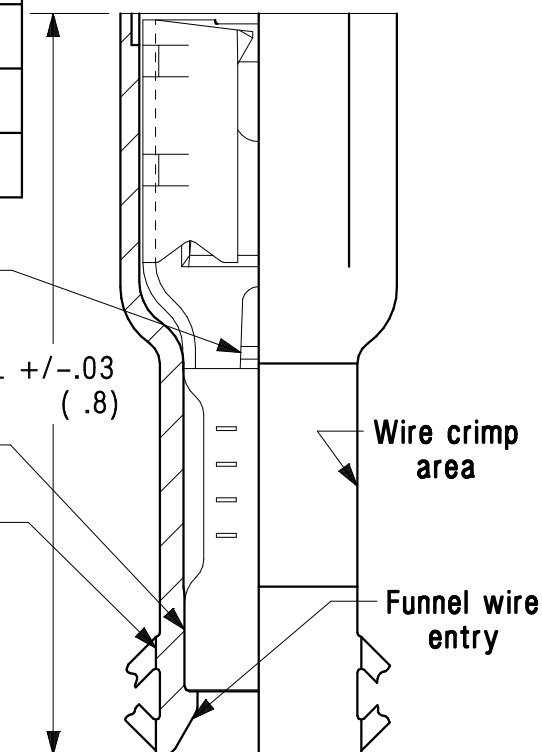
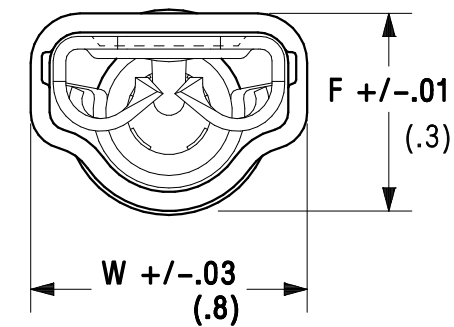

**Notes:**

- Used for:
  - A. 600V max voltage rating
  - B. 257°F (125°C) max temperature rating
  - C. Stranded copper wire only
- Wire strip length:
  - 250: 1/4 <sup>+1/32</sup><sub>-0</sub> (6.4 <sup>+8</sup><sub>-0</sub>)
  - 187,188: 9/32 <sup>+1/32</sup><sub>-0</sub> (7.1 <sup>+8</sup><sub>-0</sub>)
- Material:
  - A. Stamping - Tin plated brass
  - B. Housing - Nylon
- Packaging:
  - 3k = 3000 piece reel
- Dimensions in brackets are in millimeters or mm<sup>2</sup>

7. DNG14-188FB is UL RECOGNIZED for use with COPPER ALLOY TABS ONLY.



PANDUIT PART NUMBERS SHOWN ON THIS DRAWING MEET THE MATERIAL REQUIREMENTS OF RoHS (EUROPEAN DIRECTIVES 2002/95/EC)

07	9/06	DAW	DAW	REMOVED * FROM ASSEMBLED PART DNG14-187FB ADDED RoHS NOTE	TR00161	TRO	LCA
06	01/06	DAW	DAW	REVISED NOTE 7, ADDING WORDING "COPPER ALLOY" AND REMOVING WORDING "BRASS TABS ONLY"	TR00069	TRO	LCA
05	8/02	SAB	SKB	ADDED TOOLS CP-862, CA9, CD9-15A, & CD9-16A, ADDED NOTE 7, & WIRE RANGE AWG WAS (0.5 - 1.5) FOR DNG18-187FB, DNG18-188FB, & DNG18-250FB	10316	TRO	LA
04	10/97	TM	JD	ADDED 187 & 188 PARTS, UPDATED CHART	06413	DH	LA
REV	DATE	BY	CHK	DESCRIPTION	ECN #	PM	CUST

A41571\_07

**PANDUIT** CORP. TINLEY PARK, ILLINOIS

Reel Smart™ Supra-Grip™  
Fully Insulated Female Disconnect

DRAWN BY	BDK	CHK'D	RLS	SCALE	None	DRAWING NO./CAD FILENAME	A41571
----------	-----	-------	-----	-------	------	--------------------------	--------